



24 Henry Street
Haslington

£895 PCM



STEPHENSON BROWNE

24 Henry Street, Haslington CW1 5PS

£895 PCM

AVAILABLE NOW! This delightful semi-detached house located on Henry Street in Haslington, offers a perfect blend of character and modern living. Built in 1900, the property boasts a generous 1,141 square feet of well-designed space, making it an ideal family home.

Upon entering, you are greeted by two inviting reception rooms that are bathed in natural light, thanks to an open archway that seamlessly connects the living area to the dining space. The galley kitchen is equipped with essential appliances and leads directly to a convenient shower room. At the rear, a lovely conservatory or sunroom provides a tranquil spot to relax, overlooking a beautifully maintained garden. This outdoor space features stone pathways and ample room for seating, perfect for enjoying sunny days.

The first floor comprises two spacious double bedrooms, alongside a third bedroom located at the rear of the property, offering flexibility for family living or guest accommodation.

NOT TO SCALE These floor plans are given as a guide only. Full completed measurements and details should be verified by any intending purchasers legal representative.

36 High Street, Sandbach, Cheshire, CW11 1AN Tel: 01270 763200 opt 2

NOTICE: Stephenson Browne for themselves and for the vendors or lessors of this property whose agents they are give notice that: (1) the particulars are set out as a general guideline only for the guidance of intending purchasers or lessees, and do not constitute, nor constitute part of, an offer or contract; (2) all descriptions, dimensions, references to condition and necessary permissions for use and occupation, and other details are given in good faith and are believed to be correct but any intending purchasers or tenants should not rely on them as statements or representations of fact but must satisfy themselves by inspection or otherwise as to the correctness of each theme; (3) no person in the employment of Stephenson Browne has any authority to make representation or warranty whatever in relation to this property. (4) fixtures & fittings are subject to a formal list supplied by the vendors solicitors. **Referring to:** Move with Us Ltd **Average Fee:** £123.64







GROUND FLOOR

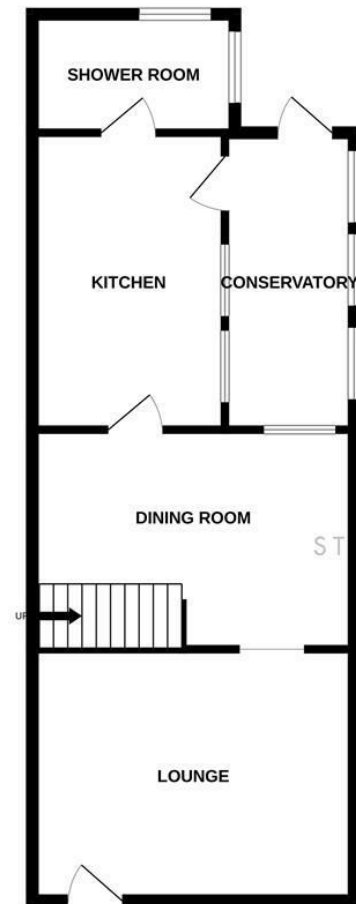

1ST FLOOR

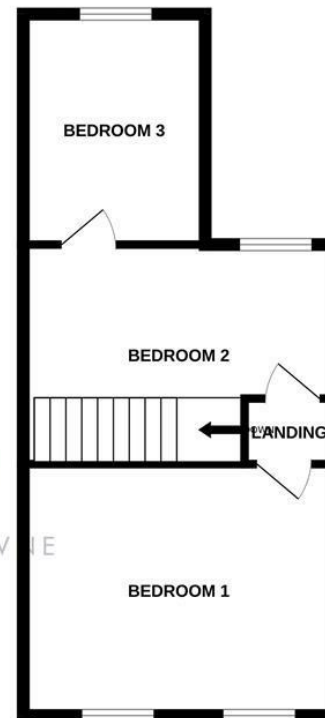

Whilst every attempt has been made to ensure the accuracy of the floorplan contained here, measurements of doors, windows, rooms and any other items are approximate and no responsibility is taken for any error, omission or mis-statement. This plan is for illustrative purposes only and should be used as such by any prospective purchaser. The services, systems and appliances shown have not been tested and no guarantee as to their operability or efficiency can be given.
Made with Metropix ©2025

